

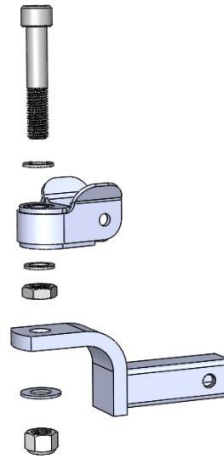

## MC169 INSTRUCTIONS

### ASSEMBLY LAYOUT

- 1 1"-8 X 5.5" SOCKET HEAD CAP SCREW
- 2 OILITE BUSHING
- 3 YOKE ASSEMBLY
- 4 OILITE BUSHING
- 5 1"-8 JAM NUT
- 6 BALL MOUNT
- 7 1"ID STEEL WASHER
- 8 1"-8 NYLON LOCKING NUT



To set up your Max Coupler, you will need either our Adjustable Channel Mount (MC212) or a ball mount that puts the mounting surface at the height you need for your trailer.

The jam nut should be hand tight, then drop the assembly onto the ball mount to install the washer and nylon locking nut. Serviceable thread locking compound is recommended for extra insurance against loosening and torque to 100 ft/lbs.

Check the assembly again after a couple hundred miles and periodically when towing to ensure the entire assembly is secure.

A couple squirts of grease is all it needs every once and a while, depending on how much you drive and the conditions. If you encounter wet, muddy conditions, a thorough cleaning and re-greasing is recommended before storing.