



To set up your Max Coupler, choose a ball mount (6) that puts the mounting surface at a height you need for your tow vehicle/trailer combination.

The tow vehicle side, or Yoke Assembly (4), has been pre-assembled to ease final installation. The threaded washer (5) may have loosened during shipping, so make sure it is hand tight against the bottom of the yoke assembly (4). The supplied Loctite thread locker can be applied to the exposed threads below the ball mount (6). Then install the steel washer (2) and nylock nut (7). Tighten to 80 ft/lbs of torque and try turning the yoke assembly from side to side and make sure there are not any gaps between the stack-up. If it is too difficult to turn it side to side by hand, try installing the trailer side of the coupler with the hitch pin in place and try it again. If you can not turn it with the extra leverage, back off the nylock nut a bit and try it again. You are going for no gaps or wobble in the mounting bolt with slight resistance when then yoke is turned side to side. Check this bolt assembly after a short distance of driving, making sure it has settled in and is tight. The 5" long bolt has been coated with grease when assembled, and you may need to lightly re-coat it with grease to keep it rotating quietly.

You will need to fill the coupler body with automotive grease before using. Put in about 10 pumps of a standard grease gun and spin the coupler so it distributes the grease and then put a couple more pumps of grease for good measure. If you encounter water crossings or inclement weather on your adventure, we recommend removing the coupler body from the trailer, remove the grease seal from the open end, and stand the coupler on its end to allow any water to drain out. Replace grease as needed.

When towing a trailer, use caution when backing up! Be aware of jack-knifing the trailer and the damage it can cause. When you are finished off road, do a safety check of your vehicle and trailer before you hit the highway. Better safe than sorry! Always obey the posted speed limits.

The Max Coupler is covered for 2 years from the date of purchase for all defects.

Thank you for your purchase! Thank you for keeping America working!

Please support our troops! We do!

Any questions, email us at info@cuoffroad.com

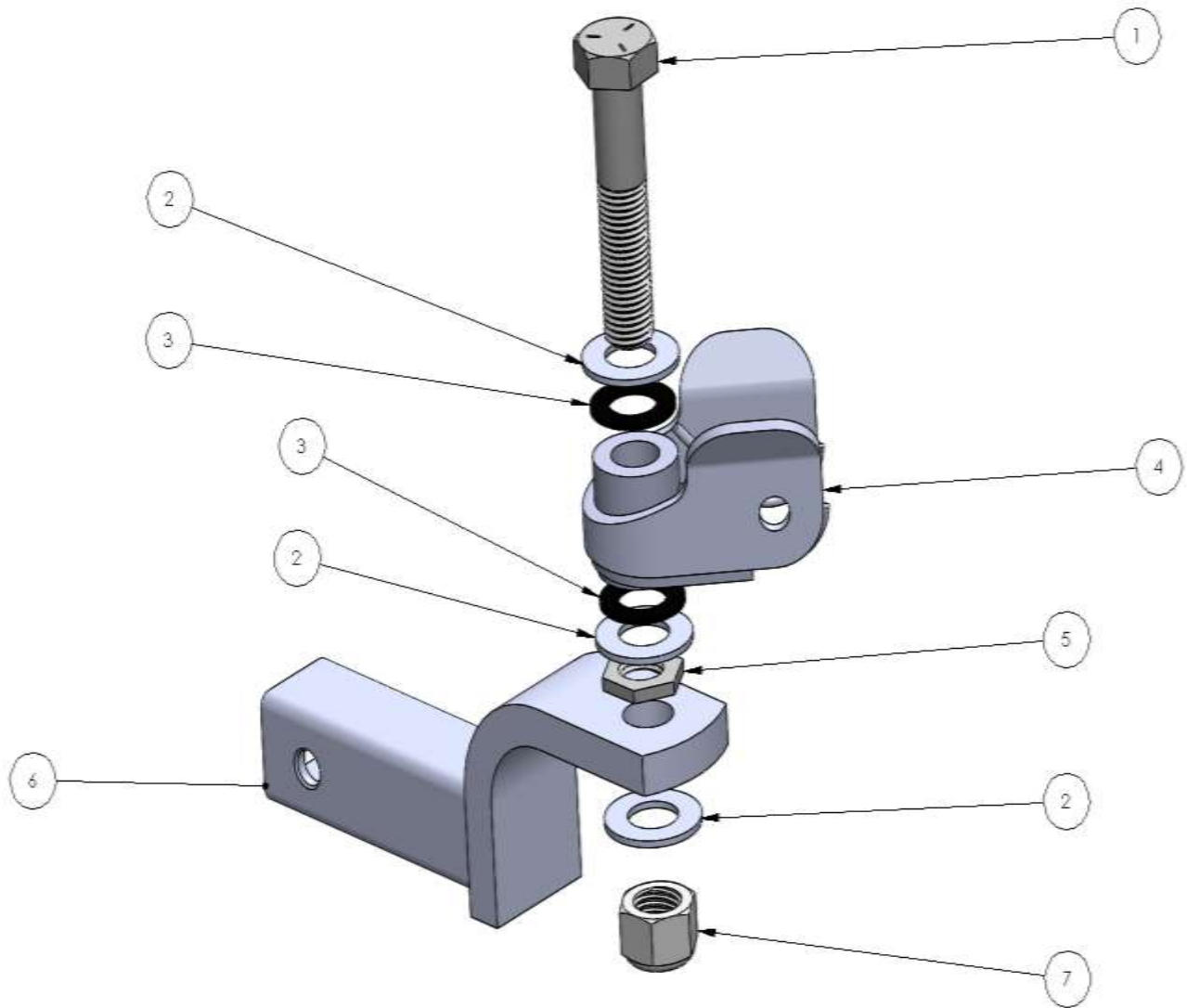

1. 1"-8 x 3" Bolt

2. Washer, Steel

3. Washer, Delrin

4. Yoke Assembly

5. Threaded Washer

6. Ball Mount

7. 1"-8 Nylon Locking Nut